

Hämmer/Hammer/Boorhamer

| Type Denomination Type | Einsteckende Shank Size Insteekeinde | Geräte Nr. Part No. Onderdeel Nr. | Masse Weight (kg) Gewicht (kg) |
|------------------------------|--|---|--------------------------------------|
| BH9 V T | S22x82,5 | 4-000-000-03562 | 15,4 |
| BH9 V T | S22x108 | 4-000-000-03563 | 15,8 |
| BH9 V T | S19x108 | 4-000-000-03561 | 16,0 |
| BH9 V T | S19x82,5 | 4-000-000-03560 | 15,5 |
| BH9 V TH | S22x82,5 | 4-000-000-03566 | 15,1 |
| BH9 V TH | S22x108 | 4-000-000-03567 | 15,5 |
| BH9 V TH | S19x108 | 4-000-000-03565 | 15,5 |
| BH9 V TH | S19x82,5 | 4-000-000-03564 | 15,1 |

Ersatzteilliste/Spare Parts List/Onderdeellijst

| Type | Benennung | Denomination | Omschrijving | BBG Nr. | Pos. | Stk. |
|------|--------------------------|-----------------------------|--------------------------|-----------------|------|------|
| ALLE | Griffkörper kpl. | Handle body cpl. | Handgreep cpl. | 3-000-000-22293 | 1 | 1 |
| ALLE | Griffkörper | Handle body | Handgreep | 3-000-000-22259 | 1.1 | 1 |
| ALLE | Griff | Handle | Handgreep | 1-000-000-69597 | 1.2 | 1 |
| ALLE | Connex-Spannstift | Connex-Pin | Connex-Spanstift | 1-000-000-70581 | 1.3 | 1 |
| ALLE | Connex-Spannstift | Connex-Pin | Connex-Spanstift | 1-000-000-69605 | 1.4 | 2 |
| ALLE | Druckfeder | Pressure Spring | Drukveer | 1-000-000-70485 | 1.5 | 2 |
| ALLE | Drücker | Trigger | Drukker | 1-000-000-69659 | 1.6 | 1 |
| ALLE | Hebel | Lever | Klink | 1-000-000-69547 | 1.7 | 2 |
| ALLE | Griffhülle | Handle Grip | Handgreep | 1-000-000-71238 | 1.8 | 2 |
| ALLE | Ventilstift | Valve pin | Ventielstift | 1-000-000-69549 | 1.9 | 1 |
| ALLE | Kugel | Valve Ball | Kogel | 1-000-000-76052 | 1.10 | 1 |
| ALLE | Einlassfeder | Inlet spring | Inlaatveer | 1-000-000-69581 | 1.11 | 1 |
| ALLE | Anschlagmutter | Stop Nut | Dekmoer | 1-000-000-68263 | 1.12 | 1 |
| ALLE | O-Ring | O-Ring | O-Ring | 1-000-000-68291 | 1.13 | 1 |
| ALLE | Krümmmer kpl. | Elbow cpl. | Inlaatstuk kpl. | 3-000-000-22081 | 1.14 | 1 |
| ALLE | Spannstift | Dowel pin | Spanstift | 1-000-000-68888 | 1.15 | 1 |
| ALLE | Verschlusschraube | Screw plug | Dopschroef | 1-000-000-69965 | 1.16 | 1 |
| ALLE | Spühlrohrgehäuse | Flushing Tube Cover | Spoelhuisdeksel | 1-000-000-77240 | 2 | 1 |
| ALLE | Steuergehäusedeckel kpl. | Control casing cover cpl. | Stuurhuisdeksel kpl. | 3-000-000-22261 | 3 | 1 |
| ALLE | Steuergehäusedeckel | Control casing cover | Stuurhuisdeksel | 1-000-000-69537 | 3.1 | 1 |
| ALLE | König-Expander | König-Expander | Koenig-Expansiestift | 1-000-000-70576 | 3.2 | 2 |
| ALLE | Steuerkörper | Control body | Stuurschijf | 1-000-000-76156 | 4 | 1 |
| ALLE | O-Ring | O-Ring | O-Ring | 1-000-000-69714 | 5 | 1 |
| ALLE | Spülrrohrspanner | Flushing Tube Clamp | Inbusbout | 3-000-000-22279 | 6 | 1 |
| ALLE | Spülrrohr kpl. S19, S119 | Flushing Tube cpl. S19,S119 | Spoelpijp kpl. S19, S119 | 1-000-000-78946 | 7 | 1 |
| ALLE | Spülrrohr kpl. S22, S122 | Flushing Tube cpl. S22,S122 | Spoelpijp kpl. S22, S122 | 1-000-000-69520 | 7 | 1 |

Ersatzteilliste/Spares Parts List/Onderdeellijst

| Type | Benennung | Denomination | Omschrijving | BBG Nr. | Pos. | Stk. |
|----------------|--------------------------|------------------------------|----------------------------|-----------------|------|------|
| ALLE | Zylinder | Cylinder | Cilinder | 3-000-000-22263 | 8 | 1 |
| ALLE | O-Ring | O-Ring | O-Ring | 1-000-000-71342 | 9 | 1 |
| ALLE | Connex-Spannstift | Connex-Pin | Connex-Spanstift | 1-000-000-69573 | 10 | 2 |
| ALLE | Kolben | Piston | Zuiger | 3-000-000-22280 | 11 | 1 |
| ALLE | Bimetall Sperrrad | Bimetall Rack wheel | Bimetall Palwiel | 1-000-000-80627 | 12 | 1 |
| ALLE | Hülse | Sleeve | Ventielhuls | 1-000-000-78905 | 13 | 2 |
| ALLE | Bohrerhülse S19x82,5 | Drill chuck S19x82,5 | Boorhuls S19x82,5 | 1-000-000-76997 | 14 | 1 |
| ALLE | Bohrerhülse S19x108 | Drill chuck S19x108 | Boorhuls S19x108 | 1-000-000-76990 | 14 | 1 |
| ALLE | Bohrerhülse S22x82,5 | Drill chuck S22x82,5 | Boorhuls S22x82,5 | 1-000-000-76998 | 14 | 1 |
| ALLE | Bohrerhülse S22x108 | Drill chuck S22x108 | Boorhuls S22x108 | 1-000-000-76992 | 14 | 1 |
| BH9 VTH | Vordergehäuse S22,S19 | Fronthead housing S22,S19 | Voorhuis S22,S19 | 3-000-000-24799 | 15 | 1 |
| BH9 VTH | Vordergehäuse S122,S119 | Fronthead housing S122,S119 | Voorhuis S122,S119 | 3-000-000-22264 | 15 | 1 |
| BH9 VT | Vordergehäuse kpl. S19 | Fronthead housing kpl. S19 | Voorhuis kpl. S19 | 3-000-000-26016 | 15 | 1 |
| BH9 VT | Vordergehäuse kpl. S22 | Fronthead housing cpl. S22 | Voorhuis kpl. S22 | 3-000-000-25686 | 15 | 1 |
| BH9 VT | Vordergehäuse S22, S19 | Fronthead housing S22, S19 | Vorrhuis S22, S19 | 1-000-000-69543 | 15.1 | 1 |
| BH9 VT | Vordergehäuse kpl. S119 | Fronthead housing cpl. S119 | Voorhuis kpl. S119 | 3-000-000-26017 | 15 | 1 |
| BH9 VT | Vordergehäuse kpl. S122 | Fronthead housing cpl. S122 | Voorhuis kpl. S122 | 3-000-000-25701 | 15 | 1 |
| BH9 VT | Vordergehäuse S122, S119 | Fronthead housing S122, S119 | Voorhuis S122, S119 | 1-000-000-69553 | 15.1 | 1 |
| BH9 VT | Bolzen | Bolt | Bout | 1-000-000-69540 | 15.2 | 1 |
| BH9 VT | Connex-Spannstift | Connex-Pin | Connex-Spanstift | 1-000-000-70236 | 15.3 | 1 |
| BH9 VT | Druckplatte | Pressure Plate | Drukdeksel | 1-000-000-69541 | 15.4 | 1 |
| BH9 VT | Drucksegment | Pressure Segment | Druksegment | 1-000-000-69542 | 15.5 | 1 |
| BH9 VT | Haltebügel S19,S119 | Steel retainer S19,S119 | Houderbeugel S19,S119 | 1-000-000-69539 | 15.6 | 1 |
| BH9 VT | Haltebügel S22,S122 | Steel retainer S22,S122 | Houderbeugel S22,S122 | 1-000-000-80072 | 15.6 | 1 |
| BH9 VTH | Sicherungsring | Retaining ring | Borgring | 1-000-000-71780 | 16 | 1 |
| BH9 VTH | Haltekappe S19,S119 | Retainer cap S19,S119 | Beitelkap S19,S119 | 1-000-000-69546 | 17 | 1 |
| BH9 VTH | Haltekappe S22, S122 | Retainer cap S22, S122 | Beitelkap S22, S122 | 1-000-000-69555 | 17 | 1 |
| BH9 VTH | Pufferring S19,S119 | Buffer ring S19,S119 | Buffer ring S19,S119 | 1-000-000-69563 | 18 | 1 |
| BH9 VTH | Pufferring S22, S122 | Buffer ring S22, S122 | Buffer ring S22, S122 | 1-000-000-76109 | 18 | 1 |
| ALLE | Nadelrolle | Needle Roller | Naalden | 1-000-000-69736 | 19 | 8 |
| ALLE | Spannschraube | Tensioning screw | Spanbout | 1-000-000-75896 | 20 | 2 |
| ALLE | Mutter | Nut | Moer | 1-000-000-73145 | 21 | 2 |
| ALLE | Schalldämpfer Oberteil | Upper part of silencer | Geluiddemper Bovenste deel | 1-000-000-69750 | 22 | 1 |
| ALLE | Schalldämpfer Unterteil | Base part of Silencer | Geluiddemper Onderste deel | 1-000-000-69752 | 23 | 1 |

Zubehör/Accessories:

| | | | | | |
|-----|----------------------|------------------------|------------------------------|-----------------|-----|
| BH9 | Anschlussnippel kpl. | Connecting Nipple cpl. | Aansluitnippel met zeef cpl. | 3-000-000-22297 | 1 |
| BH9 | Anschlussnippel | Connecting Nipple | Aansluitnippel met zeef | 1-000-000-69953 | 1.1 |
| BH9 | O-Ring | O-Ring | O-Ring | 1-000-000-69797 | 1.2 |

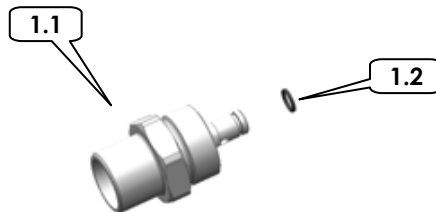

Zubehör/Accessories:

| | | | | | |
|-----|-----------------------|------------------------|-------------------------|-----------------|------|
| BH9 | Wasseranschlussventil | Water Connection Valve | | 3-000-000-22294 | 1 |
| BH9 | O-Ring | O-Ring | O-Ring | 1-000-000-69797 | 1.1 |
| BH9 | Quad-Ring | Quad-Ring | | 1-000-000-69590 | 1.2 |
| BH9 | Druckfeder | Pressure Spring | Drukveer | 1-000-000-69591 | 1.3 |
| BH9 | Scheibe | Disc | | 1-000-000-69592 | 1.4 |
| BH9 | Sicherungsring | Retaining Ring | Borgring | 1-000-000-69593 | 1.5 |
| BH9 | Kugel | V-Ball | Kogel | 1-000-000-69594 | 1.6 |
| BH9 | Ventilkolben | Valve Piston | | 1-000-000-69595 | 1.7 |
| BH9 | Anschlussnippel | Connecting Nipple | Aansluitnippel met zeef | 3-000-000-22278 | 1.8 |
| BH9 | Umsteckbolzen | Replug Bolt | | 1-000-000-69525 | 1.9 |
| BH9 | O-Ring | O-Ring | O-Ring | 1-000-000-69777 | 1.10 |

